



Egmont A&P
Association

14th–17th November 2024



EQUESTRIAN SCHEDULE

Our People

President Dale Moseley

Executive Committee

Vice President – Georgina Maud

Honorary Solicitor - Halliwells Barristers and Solicitors

Treasurer – Tom Butler

David Turner, William Brewer, Andrew Corrigan, Walter Smyth, Richard Brewer,
Ben Abbott, Malcolm Hurley, Alex Corrigan, Mark Nicholas

Show Committee

Jocelyn Baldwin, Claire Norton, Stephen & Lynette Gopperth, Gerardine Wood

Honorary Life Members

Athol Curtis, Diane Jellyman, Cate Thomson, Graham Johnson, Lesley Pease,
Julie & Donald Williamson, Tui & Michael Steele,
Hazel Robinson, Richard Brewer, Wayne Bigham, Walter & Linda Smyth,
William Brewer, Phil Dickey & Jen Blyde

Staff

Surface Specialist – Malcolm Hurley

Office Administrator – Angela Pennefather

Caretaker – Ian Careswell

Equestrian Stewards

Walter Smyth, Dale Moseley, Dressage Taranaki, Taranaki Equestrian Jumping,
Ray Egarr

Equestrian Timetable

Thursday 14th November

8.30am Main Oval - Dressage

Friday 15th November

Obertech Group Ring 1 Main Oval - Showjumping

8.00 am - Classes 1 - 6

Offshore Plumbing Services Ltd. (OPS) Ring 2 Main Oval – Showjumping

8.00 am - Classes 7 - 11

Ring 3 Burnside Grass – Showjumping

8.00 am – Classes 12 - 16

Sideshow Alley – Show Hunter Horse

8.00am – Classes 34 - 40

Show Hunter Pony

Classes 41-51

Saturday 16th November

Obertech Group Ring 1 Main Oval - Showjumping

8.00 am – Classes 17 - 22

Offshore Plumbing Services Ltd. (OPS) Ring 2 Main Oval - Showjumping

8.00 am - Classes 23 – 27

Ring 3 Burnside Grass – Show Jumping

8.00am – Classes 28 – 33

Sideshow Alley – Show Hunter Pony

8.00am – Classes 63-69

Show Hunter Horse

Classes 52-62

Egmont A&P Association

Membership

JOIN THE EGMONT A&P ASSOCIATION TODAY!

Egmont A&P Association members assist us in achieving our goals of connecting communities, promoting our people and produce and inspiring our primary sector to be the best it can.

“In the community, for the community, by the community”

We are a not-for-profit charitable organisation and having a dedicated membership base is essential for the A&P Assn to help enable us to undertake our activities during the year. Annual Membership runs from 1 July to 30 June each year.

- Individual Membership \$35.00 per year
- Family Membership \$50.00 per year

As an Association member you will receive:

- Access to our grounds
 - Preferential bookings of all our facilities
 - A & P Show Entry
 - Exclusive pass to the Members carpark at the Show
 - Entry to our Members & Sponsors Lounge
 - Have your say at our AGM
 - Keep informed of what is going on at the Showgrounds via our Newsletter
-

For more information, please contact the office on 06 2788613 or info@egmontshowgrounds.org.nz or visit www.egmontshowgrounds.org.nz to join!

Thank you to all our sponsors for our 2024 Equestrian Event



PLUMBING & PIPELINE



Employment Lawyers & Human Resources Specialists



WT & LM Smyth





Taranaki Bulk Spreaders



Egmont A&P Show General Conditions

Dressage entries close midnight Wednesday 30th October 2024

Show Jumping & Show Hunter entries close midnight Saturday 9th November 2024

All other entries close midnight Saturday 9th November 2024

The following General Conditions are to be read in conjunction with Section Conditions and with the Rules and Bylaws of the Royal Agricultural Society (RAS) of New Zealand.

1) PRIVACY ACT

The A&P Society holds records of names and addresses of all Members, Trade Exhibitors and Competitors and may publish these for the purposes of Show media reports or promotional purposes at the A&P Associations discretion.

The A&P Association may take photographs and video images of Members, Trade Exhibitors, Competitors, exhibits (including livestock) and the employees, agents and assistants of any Trade Exhibitor or Competitor and use this information for reporting or promotional purposes in any media, at the A&P Associations discretion.

2) HEALTH & SAFETY

Competitors must:

- Comply with the appropriate animal legislation and the Health and Safety at Work Act 2015 and any amendments thereafter.
- Supervise and control their animals at all times and shall be liable for any hazards created or accident, illness or damage caused by the action of themselves or their animals at the Showgrounds. The Association reserves the right to order immediate removal from the Showgrounds any animal it considers unruly, dangerous or unmanageable.
- Follow the instructions of Marshals and Officials.
- Ensure that they keep walkways clear, and no dangerous equipment or chemicals are accessible to the public.
- Report accidents to the Show Office.

NO SMOKING or VAPING inside any buildings within the Egmont A & P Showgrounds.

All persons admitted into any premises controlled by the Egmont A&P Association shall be subject to the orders of the Committee and, in the event of misbehavior on the part of anyone attending the Show such person may be removed by order of the Association. This applies to any person whose conduct, either personal or as proprietor of a trade stand, or exhibit, is a source of annoyance.

The Egmont A&P Association will not be responsible for any accident, loss or damage that may be caused directly or indirectly to or suffered by an exhibit.

Persons occupying grandstands, buildings and other structures or other seating accommodation on the Showgrounds do so at their own risk.

The full Health & Safety Policy & Management Plan is available at the Show Office.

2.1) First Aid

First aid stations are located by the Office. Please familiarize yourself with the Showgrounds site map.

2.2) Protective Headgear/Safety Helmets

Wearing a helmet (with a yellow tag) is compulsory for anyone competing on, working in or schooling or riding for any reason a horse within the Showgrounds. Such headgear must be worn with the chinstrap properly adjusted and fastened when in the arena or ring, the practice area, collecting rings or anywhere else within the Showgrounds.

The RAS, Equestrian Sports New Zealand (ESNZ) and NZ Pony Club Association (NZPCA) have a consistent standard in approved safety helmets and use the same yellow safety tags to identify compliant helmets. Some A&P Shows and measuring stands can tag compliant helmets and any yellow tag applied by the ESNZ or NZPCA is accepted by the RAS. All helmets that conform must be identified by the current tag system.

NOTE: New 'yellow' Tags regulations come into force on 1 August 2023. For more information, please follow these links: <https://www.ras.org.nz/equestrian/health-and-safety/> or <https://www.nzequestrian.org.nz/safety/helmettagging/>

3) RIGHTS OF THE EGMONT A&P ASSOCIATION

The Egmont A&P Association reserves the right to, at any time, for any reason and without notice to:

- Refuse or cancel any entry
- Alter the Show timetable
- Withdraw or change any event or class
- Amalgamate classes where there are insufficient entries
- Remove any dangerous or inappropriate exhibit or display

The decision of the Association is final. Competitors will be notified if classes are to be amalgamated.

4) CONDITIONS OF ENTRY

- Entries for all Equestrian Sections are to be submitted by entering on Evo Events; www.evoevents.co.nz,
- Entries are not accepted until they are paid in full.
- Entries received after closing date will only be accepted at the discretion of the organisation and will incur a late fee of \$25.00
- There is no receipt of entry unless requested.
- It is the competitor's responsibility to ensure their details of entries are correct.
- Entry in the Show entitles the Egmont A&P Association to publish a competitors' name in results and distribute with Competitor Lists.
- The Association reserves the right to refuse or cancel any entry without adducing any reason for doing so.

Competitor Entry	Fee
Ground Levy Per horse	\$20.00
Medical & Admin levy per rider (Non refundable)	\$15.00
Camping Fee per Truck/ Float (Unpowered) * there are no powered sites available	\$20.00
Covered Yard/Stable for <u>event</u>	\$80.00
Covered Yard/Stable for <u>one day or night</u>	\$40.00
Open Yard for <u>event</u>	\$45.00
Open yard for <u>one day or night</u>	\$20.00

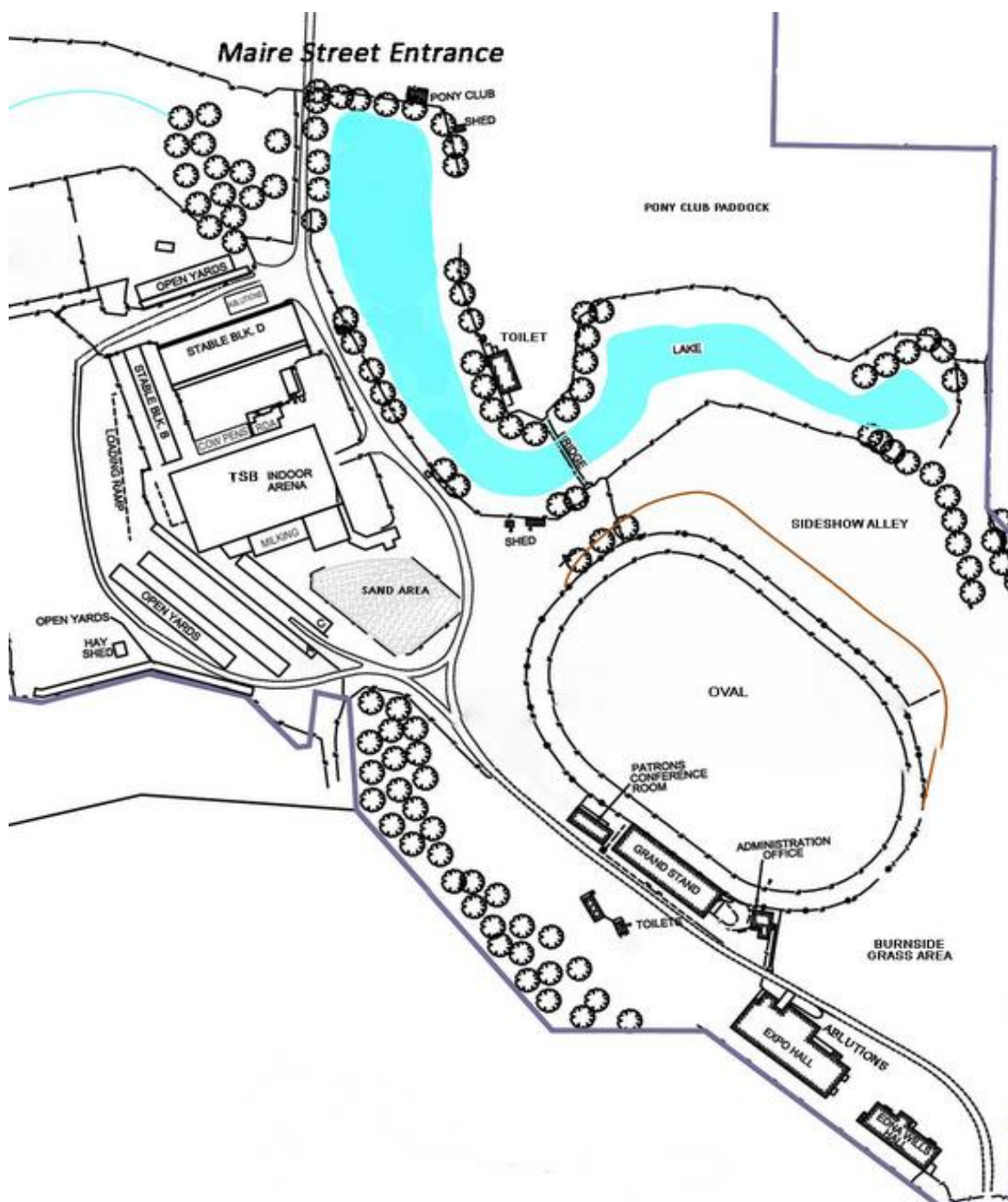

5) SCRATCHINGS

- Application for refunds must include a vet certificate or medical certificate.
- 100% refund will be paid until close of entry.
- 50% refund will be paid from close of entry.
- Competitors are encouraged to do their scratching's via My Entries on Evo Events AND notify the Office.

6) PARKING

- ALL equestrian vehicles MUST enter via Maire Street Entrance
- ***Double gates by Norfolk Pine tree are to be kept closed at all times***
- No parking around the horse stalls
- Exit using Maire Street

7) ACCOMMODATION

- Camping fee of \$20.00 per truck or float per night **** There are no powered camping sites available****

-Showers and toilets are provided.

8) STABLING/YARDING

- Stables and yards cannot be guaranteed as they are limited.
- Temporary yards are NOT permitted. This includes taped areas at the truck or float.
- Stallion boxes must have sign denoting "STALLION" on outside of box.

8.1) Stabling/Yarding Bond

- Stabling/ yarding will be issues in order of entry with preference to visitors, organising committee, sponsors, volunteers and those competing at a higher level.
- On arrival all yards and stables will be clean.
- It is the responsibility of the competitor that has been allocated the yard/stable to keep the yard/stable clean and free of rubbish.
- All wet & dirty straw, sawdust etc must be removed from the yard/stable and cleaned out at the conclusion of the Show.
- Competitors are to take photographic evidence prior to departing, please only send these photos in if requested where there is a dispute.
- An Egmont A&P Association Official will be assessing the state yards and stables are left in by the occupying competitor, after the Show. If the yard/stable is not left in satisfactory condition, photographic evidence including yard/stable number will be taken and the competitor will be invoiced \$75.00 and may not have a yard / stable allocated to them in the future.

9) RULES

- ESNZ rules apply to all Dressage and Show Jumping competitors.
- RAS rules apply to all showing, sport and pleasure horse competitors.
- The RAS Judges & Competitors Rulebook (see www.ras.org.nz) sets out all the conditions that apply to the classes and sections offered.
- Should any person or firm be disqualified or suspended by another Association or affiliated organisation of the Royal Agricultural Society, the suspension or disqualification may also be applied by the affiliate organisations.

10) STARTING TIMES

- Starting times are approximate only but the Show will endeavor to adhere to as closely as possible. When a competitor may have two classes they have entered running simultaneously then they must elect which class they compete in. Our judges and stewards will do their best to work in with everyone to the best of their ability.
- To be read in conjunction with the relevant section conditions and rules and By-Laws of the Royal Agricultural Society of New Zealand.

11) LATE ENTRIES & CHANGES DURING THE SHOW

- Late entries will only be accepted at the discretion of the organisation and will incur a late fee of \$25.00
- Competitors can place additional/change entries during the Show for the following day's events. These entries MUST be made at the Horse Office by 5pm the day prior to the competition to allow for alterations of the judging sheets. A 25% surcharge may apply and must be paid at the time the additional entry is made. These riders will go first in the class where it is draw order.
- Substitutions are permitted provided the original equine that is being substituted, takes no further part in this Show. The substitution can only be made into the same class as the original entry and be owned by the same person. Vet certificates are not required. Substitutions MUST be made at the Show Office by 5pm the day prior to the competition to allow for alterations of the judging sheets.

12) PROTESTS

- All protests must be in writing and may be lodged with the Section Chief Steward/Section Head one hour from the completion of the class judged, together with a deposit of \$50 which shall be returned should the protest to upheld. No protest will be received later than one hour after the ribbons are affixed.

13) TROPHIES & CUPS

- All Cups and trophies will be available for awarding and photography purposes ONLY and will be engraved at the Egmont A & P Associations expense.
- No Cups and trophies are to leave the Egmont A&P Showgrounds.

14) PREPARATION FOR DEPARTURE

- Clean out all yards/stables, as you found them – refer to 'Yard/Stabling Bond' pg. 9
- Notify the Office of any damage or repairs and maintenance required.
- Remove all rubbish and personal belongings.
- Check your individual schedules for any specific details related to the section.
- Pay all outstanding fees before departing the Showgrounds.

15) PRIZE MONEY

- Any prize money will be paid into a nominated bank account within 30 days (subject to any queries). Please enter this on Evo Events when entering.
- Bank accounts must be verified before payments will be made.
- Any disputes regarding prize money must be made no later than 30 November.
- The payout scale (excluding Show Hunter and Show Jumping) is as follows:
 - a. In classes with three (3) or less entries, only 1 place will be awarded and paid.
 - b. In classes with four (4) to six (6) entries, 1st and second place will be awarded and paid.
 - c. In classes with seven (7) or more entries, all prize money will be awarded and paid.
- For Show Hunter and non ESNZ series Show Jumping classes, all advertised prize money will be paid out as per jumping rules Art 248.7.
- For Series Classes this show will not pay prize money where riders incur 12 faults or more in the first round.
- Winners will be contacted by the Competitions Team via email to verify their bank account if required.

16) REFUND POLICY

The Committee reserve the right to request a veterinarian or Doctors certificate if any competitor requires a refund. Application for refunds to be in writing within 14 days of the show. 75% of entries fees only will be refunded, no refunds under \$20 will be made except where grading affects the class.

17) BIOSECURITY

The Egmont A&P Society supports all appropriate biosecurity regulations.

18) BEHAVIOUR & CONDUCT – In-Line Resolution Process/ ESNZ Official Warning Card

- This Show supports the RAS In-Line Resolution Process Policy, which will operate in all sections and will be used for any inappropriate behaviour towards Show officials, judges, fellow competitors or any other third party connected with the Show.
- The full working of the policy is available to view on the RAS website www.ras.org.nz

-ESNZ Official Warning Card may be issued, in cases of offences in respect of abuse of animals or inappropriate behaviour as per Dressage NZ, ESNZ Jumping and /or ESNZ Rules and General Regulations Full information on ESNZ Official Warning Card procedure can be found at www.nzequestrian.org.nz.

19) CLEAN SPORT TESTING

- The use of tranquilizers, stimulants or any drugs capable of affecting the performance of horses and ponies is forbidden.
- Competitors are advised that tests for forbidden substances may be carried out during the Show and that testing of animals is at the risk of the person that is responsible. Clean Sport testing will be carried out under the RAS (Incorporated) CleanSport Judicial Committee (CSJC) procedures and rules.
- Any competitor who has administered to their horse or pony any drug during seven days prior to the show is required to notify the secretary and fill out a medication advice form before competing.
- ESNZ Blue Card rules for concussion will apply in both Dressage and Jumping Sections.

20) WHISKER AND INNER EAR TRIMMING FOR HORSES AND PONIES

- As from 1 January 2022 there is to be no trimming of whiskers, eye or inner ear hair/whiskers of horses/ponies competing at RAS affiliated A&P Shows/Events. This is in line with the same animal welfare approach taken by the Equestrian Sport New Zealand (ESNZ) and New Zealand Pony Clubs Association (NZPCA). The below link provides more detail on what is and is not permitted.
- <https://www.ras.org.nz/equestrian/whisker-and-inner-ear-trimming/>

21) HEIGHT CERTIFICATES

- The Measuring Rules of the RAS apply to this Show.
- Height certificates and novice status cards must be carried at all times and presented on demand otherwise the competitor will not be allowed to start.
- Competitors in any class where a height certificate is required may not leave the ring to obtain a certificate and will forfeit awards if certificate is not shown. Microchips do not exempt riders from carrying a height certificate.
- Competitors are advised of all measuring days and times which are set prior to entries closing for the Show.
- No measuring will be carried out between the closing of entries and the Show.

22) STALLIONS AND COLTS

- All 'day travelling' stallions and colts must be attended to and supervised at all times by an adult OR placed into a stallion box (to be paid for in entries).
- Stallion boxes must have sign denoting "STALLION" on outside of box.
- All stallions and colts (with the exception of miniature horses and foals) must be shown in a bit and it is compulsory for all stallions and colts to wear (2) official "S" identification badges, one attached to each side of their bridle. The rider and handler must also wear (2) official RAS armbands (one on each arm) when in the ring. Badges can be purchased from RAS Head Office or ESNZ and armbands from RAS Head Office.
- Handlers and Riders must be 17yrs or older and wear an approved Hi-vis vest when outside the showing ring which can be purchased from RAS Head Office.

23) AGE OF RIDERS, HANDLERS, HORSES & PONIES

- Riders and Handlers age eligibility is determined as at the 1 August and stays in that division/section for the complete Show year/season. Proof of age may be required and should be on hand.
- Novice pony stallions must be led or ridden by a rider 14 years & over.
- Open pony stallions must be ridden by a rider 14 - 16 years and led handlers must be 14 years & over.
- Stallions over 148cm must be ridden or led by a rider/handler 17 years & over.
- Horses over 148cm must be ridden by a rider 12 years & over (except for stallions).
- Horses/Ponies under three (3) years of age are not permitted in any ridden or driven (harness) class no matter what the rules of any affiliated Breed Society or Kindred Society may prescribe.

Egmont A&P Show Section Conditions

Show Hunter

SIDE SHOW ALLEY – Draw order

Conditions of Entry

- Please read these Section Conditions alongside the General Conditions of the Egmont A&P Show.
- Horse of the Year Qualifying Show
- All riders, horses and ponies must compete with the appropriate ESNZ membership to compete in ANY Show Hunterclasses.
- Horses and ponies may compete in Show Hunter under the ESNZ casual levy system but if riding on a casual registration will not be awarded any LRHOY qualifying points.
- Run under ESNZ Show Hunter rules & series conditions.
- Riders may enter only one equitation class per day.
- **No Practice rounds**
- Show Hunter Guidelines for Ponies:
 - o Cat A: Ponies 133cm & under 3.05m (10') stride
 - o Cat B: Ponies over 133cm and up to and including 143cm; 3.20m (10'6") stride
 - o Cat C: Ponies over 143cm and up to and including 148cm; 3.35m (11') stride

Arrival: Gate entry through Maire Street Gate

Show Jumping

OVAL & BURNSIDE GRASS

Ring 1 Sponsored by: Obertech Group

Ring 2 Sponsored by: Offshore Plumbing Services

Conditions of Entry

- Please read these Section Conditions alongside the General Conditions of the Egmont A&P Show.
- These apply to jumping events where applicable, including regulations governing Certificates of Height.
- A horse/pony may only have two starts per day as per ESNZ
- If classes have excess entries the classes will be divided, and prize money adjusted.

Time of Events

- Times stated in the Schedule for Jumping Competitions are approximate only and will be adjusted after entries close according to entries received. The Egmont A&P Show reserves the right to start an event before the catalogued time.
- Overlap - Consideration shall be shown to competitors who are entered in competition that may overlap. Please see the Senior Steward concerned but classes will not be delayed.
- In Ring 1, Competitors must jump in the order as drawn and printed in tile Catalogue. All riders must be suitably attired when entering the ring.

- Ring 1 to be run in strict draw order.
- Ring 2 Blackboard order (Except Series Classes)
- Ring 3 Black board order



ESNZ

- All riders must be ESNZ registered.
- For all classes, (except introductory classes) riders must have a full ESNZ membership, horses must be registered with ESNZ and have a current ESNZ Jumping annual start.
- ESNZ fees will be charged as per ESNZ guidelines on Evo Events.
- Horses are restricted to .90m and under.
- Ponies are restricted to .80m and under.
- Horses and Ponies cannot compete in Series Classes with Casual Start.
- Classes are run under ESNZ Rules and Regulations. For conditions of the series classes please visit www.nzequestrian.org.nz

Egmont Horse Coaches Pony Points Prize

The Egmont Horse Coaches Pony Points Competition is held over the Taranaki Show jumping circuit in selected classes beginning at Waverley A&P, Egmont A&P, Taranaki Equestrian Jumping Spring Spectacular, Stratford A&P and ends at the Taranaki Equestrian Jumping Show in January. Points are allocated 5,3,2,1 at each show and the "John Henry" cup is presented to the leading Taranaki rider at the completion of the series.

Arrival: Gate entry through Maire Street Gate



Showing

PONY CLUB Paddock

Conditions of Entry

- Please read these Section Conditions alongside the General Conditions of the Egmont A&P Show.
- The use of prefixes on horses and ponies in the showing classes be those of the breeder.
- Where classes are defined by height, competitors/exhibitors must carry a current RAS Certificate for their horse/pony at all RAS affiliated Shows/Events, and must produce it upon request to any authorised Show/Event personnel. Any competitor unable to produce such a certificate means that the exhibit is ineligible to compete, and will forfeit any awards.
- If sections coincide no class will be delayed.
- RAS Exhibit Numbers showing classes - It is compulsory to display your exhibit number (exhibitor to provide) while in a RAS judging ring. This can be in a number holder or make your own armband which is worn on left arm.
- The number of Novice wins is to be counted at the time of the Show/Event, not the time of entry. If a Novice entry exceeds the permitted number of wins by the day of the Show/Event, the competitor must advise the Secretary's Office and change to an Open class, or if no class remains to enter, a refund will be actioned after the Show/Event.
- Imported Horse/Pony - Any wins gained overseas by a horse/pony that is imported into New Zealand, count towards their classification when showing in New Zealand, i.e. whether it can still compete in the Novice section (5 wins or less) , or if it has 6 or more wins, then it must compete in the Open section.

Arrival: Gate entry through Maire Street Gate

Friday 15 November Time	<i>Ring One Judge:</i>	<i>Ring Two Judge:</i>	
10am	Working Hunter Pony		
	Hunter Jumping Pony	Not before 10 am Led Horse	
	LUNCH		
Not before 1pm	Working Hunter Horse	Led Pony	
	Hunter Jumping Horse		

Saturday 16 November Time	<i>Ring One Judge:</i>	<i>Ring Two Judge:</i>	<i>Ring Three Judge:</i>
8.30am	Show Pony	Lead Rein	Show Pleasure Pony
	Show Pleasure Horse	First Ridden	Saddle Hunter Pony
	SUPREME PONY		
	Junior Rider	Best Registered Pony Class	
	LUNCH		
Not before 1pm	Hacks (Small & Large)	Riding Horse	Saddle Hunter Horse
	SUPREME HORSE		
	Best Registered Horse Class	NZTR Thoroughbred A&P Show Series	Senior Rider

Sunday 17 November Time	<i>Ring One Judge:</i>	<i>Ring Two Judge:</i>	<i>Ring Three Judge:</i>	<i>Ring Four Judge:</i>
9.00am	Recreational/Leisure Horse or Pony 17 yrs and over	Recreational/Leisure Horse or Pony – Riders 10 to 16 years	Recreational/Leisure Horse or Pony – Riders 16 years & under Lead Rein	Recreational/Leisure Horse or Pony – Riders 16 years & under walk and trot in a group, canter optional.
Not before 11.30am	Recreational/Grass roots Jumping 40cm 50cm 60cm 70cm			

DRESSAGE

Thursday 14th November, 8.30am

Venue: Main Oval/TSB Indoor Arena

Entries close online with Evo Events midnight Wednesday 30th October 2024

RULES:

1. All classes run under ESNZ rules.
2. All tests are from the Dressage NZ test book dated 1/9/2023.
3. All riders in graded classes Novice & Above must have Full ESNZ Membership current to 17/11/24.
4. Riders competing in Introductory Classes & Preliminary must be an ESNZ Introductory Annual Member or Full Membership or pay an ESNZ casual membership.
5. All ESNZ Horse/Pony registrations must be current to 17/11/24.
6. Dressage Flexi-start payable for ESNZ registered horses & ponies with no annual dressage start \$5 per test all Levels 1-4-
7. One ESNZ graded class score will qualify for Dressage Taranaki circuit points.
8. Maximum of three starts per horse.
9. Pony classes 2028/30/32/34 may only be contested by a rider 16 years and under at 1 Aug 2024
10. Pony riders 16 years and under at 1 Aug 2024 contesting any class will be eligible for the Polarlight Trophy for their two highest percentages.
11. Dressage draw will be posted on www.egmontshowgrounds.org.nz and www.evoevents.co.nz
12. All technical dressage queries, please contact show office.
13. Entries received after draw is completed can only be accepted in the place of scratching's.
14. The organising committee reserves the right to alter the program and/or prize money within the ESNZ GR's/Dressage NZ rules or cancel classes if insufficient entries.
15. Intro, Prelim, Novice & Elementary classes may be held in the Oval. Medium, Advanced Medium & Advanced classes will be held in the TSB Indoor Arena.
16. ESNZ horse registration number must be displayed at all times on both sides of the horse or pony during the dressage competition with the exclusion of Non Graded horses and ponies.

Entry Fees:

Prize Money 1st – 3rd, 4th ribbon only

Introductory/ Non-graded	\$ 12.00	Ribbons only
Levels 1, 2 and 3	\$ 18.00	1st \$30, 2nd \$22, 3rd \$18
Levels 4 and above	\$ 20.00	1st \$30, 2nd \$25, 3rd \$20

Class	Level/Test	Class	Level/Test
2000	Introductory - 1.A	2020	Advanced Medium - 1.A
2002	Introductory - 1.B	2022	Advanced Medium 1.B
2004	Preliminary - 1.A	2024	Advanced - 1.A
2006	Preliminary - 1.B	2026	Advanced - 1.B
2008	Novice - 1.A		
2010	Novice – 1.B		
2012	Elementary - 1.A	2028	Pony Preliminary - 1.A
2014	Elementary - 1.B	2030	Pony Preliminary – 1.B
2016	Medium - 1.A	2032	Pony Novice – 1.A
2018	Medium - 1.B	2034	Pony Novice – 1.B

SHOW JUMPING

Entries close online with Evo Events on Saturday 9th November at midnight.

Friday 15th November 2024



Ring 1, 8.30 am, Draw Order

Class 1	Pony Welcome Stakes Art: 274 2.5.1 (Special 2 Phase) 1.20m EF: \$20.00 PM: \$80, 60, 40, 20
Class 2	Mainland Coachwork Junior Rider Series Art: 238.2.2 1.15m – 1.25m EF: \$30.00 PM: \$100, 80, 70, 60, 50, 40
Class 3	The Brave Pants Company Pro-Amateur Rider Series Art: 238 2.2 1.20m – 1.30m EF: \$30.00 PM: \$100, 80, 70, 60, 50, 40
Class 4	Open Horse Art. 274.2.5.1 (Special 2 phase) 1.30m EF: \$30.00 PM:\$100, 80, 70, 60
Class 5	FMG Young Rider Series Art238.2.2 1.25m - 1.35m EF:\$35.00 PM: \$140 120 100 60 50 40
Class 6	Open Horse Art: 238.2.2 1.40m EF: \$40.00 PM: \$150, 120, 100



Ring 2, 8.30 am, Blackboard Order (except Series Classes)

Class 7	Open Horse Art. 274.2.5.1 (Special 2 phase) 1.0m EF\$15.00 PM:\$80.00 60 40 30
Class 8	Open Horse Art. 274.2.5.1 (Special 2 phase) 1.10m EF:\$15.00 PM: \$80 60 40 30
Class 9	Open Horse (incl. Main-Events Tertiary Series) Art. 274.2.5.1 (Special 2 phase) 1.20m EF:\$15.00 PM:\$80 60 40 30
Class 10	Open Pony Art. 274.2.5.1 (Special 2 phase) 1.0m EF:\$10.00 PM:\$30 20 15 12
Class 11	Open Pony Art. 274.2.5.1 (Special 2 phase) 1.10m

EF:\$15.00

PM:\$80

60

40

30

Ring 3, 8.30am, Blackboard Order

Class 12	Intro Pony	Art. 274.2.5.1 (Special 2 phase)	0.60m12	EF:\$12	PM: \$30	20	15	12
Class 13	Intro Pony	Art. 274.2.5.1 (Special 2 phase)	0.70m12	EF:\$12	PM: \$30	20	15	12
Class 14	Intro Pony	Art. 274.2.5.1 (Special 2 phase)	0.80m12	EF:\$12	PM: \$30	20	15	12
Class 15	Open Pony	Art. 274.2.5.1 (Special 2 phase)	0.90m12	EF:\$12	PM: \$30	20	15	12
Class 16	Intro Horse	Art. 274.2.5.1 (Special 2 phase)	0.70m12	EF:\$12	PM: \$30	20	15	12
Class 17	Intro Horse	Art. 274.2.5.1 (Special 2 phase)	0.80m12	EF:\$12	PM: \$30	20	15	12
Class 18	Intro Horse	Art. 274.2.5.1 (Special 2 phase)	0.90m12	EF EF:\$12	PM: \$30	20	15	12

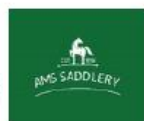

Saturday 16th November 2024

Ring 1, 8.30 am Draw Order

Class 19	Dunstan Horsefeeds Amateur Rider	Art: 238.2.2	1.10m – 1.20m	EF: \$30.00	PM:\$100, 80, 70, 60, 50, 40
Class 20	NZPH & A1 Equine Reproduction Seven Year Old Breeding Series	Art 238.2.2	1.30m	EF: \$35.00	PM: \$120, 100, 80, 60, 50,40
Class 22	Horse Mini Prix	Art 238.2.2	1.25m - 1.35m	EF:\$35.00	PM:\$120 100 80 60 50
Class 21	NZ Warmblood Association Six Year Old Breeding Series	Art 238.1.1	1.20m max	EF:\$30.00	\$250 Prize Pool
Class 23	Property Brokers Horse Grand Prix Series	Art 261.5.1.2	1.40m - 1.50m	EF:\$80.00	PM:\$450 350 250 200 150 100
Class 24	AMS Saddlery Pony Grand Prix Series	Art 261.5.1.2	1.20m - 1.30m	EF:\$30.00	PM\$100 80 70 60 50 40

Ring 2, 8.30am Blackboard Order (except Series Classes)

Class 25	East Coast Performance Horses Five Year Old Breeding Series	Art 238.1.1	1.10m max	EF:\$25.00	\$150 Prize Pool
Class 26	Ben Thomas Panel Beating	Open Horse	Art 238.2.2 1.10m	EF:\$20.00	PM\$80, 60, 40, 30
Class 27	BTW Company Ltd	Open Horse	Art 238.2.2 1.15m - 1.20m	EF:\$20.00	PM:\$80, 60, 40, 30
Class 28	Taranaki Bulk Spreaders	Open Pony	Art 238.2.2 1.10m	EF:\$15.00	PM:\$60, 40, 30, 20
Class 29	Mane Street Hair	Open Pony	Art 238.2 1.20m	EF:\$20.00	PM:\$80, 60, 40, 30

Ring 3, 8.30am, Blackboard Order

Class 30	Eltham Vet Services	Intro Horse	Art 238.2.2	0.75m EF:\$12.00 PM:\$30	20	15	12
Class 31	Action Moto	Intro Horse	Art 238.2.2	0.85m EF:\$12.00 PM:\$30	20	15	12
Class 32	Zodiac Signs	Open Horse	Art 238.2.2	0.95m EF:\$12.00 PM:\$30	20	15	12
Class 33	Primo	Open Horse	Art 238.2.2	1.05m EF:\$12.00 PM:\$30	20	15	12
Class 34	Holdem Contracting	Intro Pony	Art 238.2.2	0.60m EF:\$12.00 PM:\$30	20	15	12
Class 35	Hunts Farm Services	Intro Pony	Art 238.2.2	0.70m EF:\$12.00 PM:\$30	20	15	12
Class 36	Agtrans	Intro Pony	Art 238.2.2	0.80m EF:\$12.00 PM:\$30	20	15	12
Class 37	Finer Spraying Services	Open Pony (incl. Egmont Horse Coaches Pony Series)	Art 238.2.2	0.90m EF:\$12.00 PM:\$30	20	15	12
Class 38	Health & Safety Lead	Open Pony	Art 238.2.2	1.0m EF:\$12.00 PM:\$30	20	15	12

Egmont A & P Show
Show Hunter Classes – Sideshow Alley
 Entries close online with Evo Events on Saturday 9th November at midnight.

Horses		Height	Entry Fee	Prize Money
Friday 15th November		Prize money 1st to 4th place		
8.30 am Start				
39	Introductory Hunter	80cm	\$8	Ribbons only
40	Welcome Hunter HOYQ	90cm	\$10	\$25, 20, 15,10
41	EquiMatch Junior High Points Series	1.0 M	\$12	\$30, 25, 15,12
42	ESNZ Show Hunter Amateur High Points Series	1.0 M	\$12	\$30, 25, 15,12
43	Auckland & Waitemata Show Hunter Groups Junior Equitation Series	1.0 M	\$12	\$30, 25, 15, 12
44	Seahorse Supplements Adult Equitation Rider Series	1.0 M	\$12	\$30, 25, 15,12
45	NRM Open Horse High Points Series	1.10 M	\$12	\$30, 25, 15,12
Ponies Category A				
46	Introductory Pony	60cm	\$8	Ribbons only
47	Pony Hunter HOYQ	70cm	\$10	\$25, 20, 15,10
48	Vero Insurance Cat A High Points Series	70cm	\$12	\$30, 25, 15,12
49	BOP & Waikato Show Hunter Groups Equitation Series- 12 years and under	70cm	\$12	\$30, 25, 15,12
Ponies Category B				
50	Introductory Pony	70cm	\$8	Ribbons only
51	Pony Hunter HOYQ	80cm	\$10	\$25, 20, 15,10
52	Grains & Gains Cat B High Points Series	80cm	\$12	\$30, 25, 15,12
Ponies Category C				
53	Introductory Pony	70cm	\$8	Ribbons only
54	Pony Hunter HOYQ	80cm	\$10	\$25, 20, 15,10
55	Big On Writing Pony Rider Equitation Series	80cm	\$12	\$30, 25, 15,12
56	The Brave Pants Company Cat C High Points Series	90cm	\$12	\$30, 25, 15,12
		Height	Entry Fee	Prize Money

Egmont A & P Show
Show Hunter Classes – Sideshow Alley
 Entries close online with Evo Events on **Saturday 9th November at midnight.**

Saturday 16th November
8.00am Start

Prize money 1st to 4th place

Ponies Category A

57	Introductory Pony	60cm	\$8	Ribbons only
58	Pony Hunter HOYQ	70cm	\$10	\$25, 20,15, 10
59	Vero Insurance Cat A High Points Series	70cm	\$12	\$30,25, 15, 12
60	BOP & Waikato Show Hunter Groups Equitation Series- 12 years and under	70cm	\$12	\$30,25, 15, 12

Ponies Category B

61	Introductory Pony	70cm	\$8	Ribbons only
62	Pony Hunter HOYQ	80cm	\$10	\$25, 20,15, 10
63	Grains & Gains Cat B High Points Series	80cm	\$12	\$30,25, 15, 12

Ponies Category C

64	Introductory Pony	70cm	\$8	Ribbons only
65	Pony Hunter HOYQ	80cm	\$10	\$25, 20,15, 10
66	Big On Writing Pony Rider Equitation Series	80cm	\$12	\$30,25, 15, 12
67	The Brave Pants Company Cat C High Points Series	90cm	\$12	\$30,25, 15, 12

Horses

68	Introductory Hunter	80cm	\$8	Ribbons only
69	Welcome Hunter HOYQ	90cm	\$10	\$25, 20,15, 10
70	Equimatch Junior High Points Series	1.0 M	\$12	\$30,25, 15, 12
71	ESNZ Show Hunter Amateur High Points Series	1.0 M	\$12	\$30,25, 15, 12
72	Auckland & Waitemata Show Hunter Groups Junior Equitation Series	1.0 M	\$12	\$30,25, 15, 12
73	Seahorse Supplements Adult Equitation Rider Series	1.0 M	\$12	\$30,25, 15, 12
74	NRM Open Horse High Points Series	1.10 M	\$12	\$30,25, 15, 12



RAS SHOWING SECTION

WORKING HUNTER PONY SECTION

Friday 15th November 2024 – 10am
Entry Fee: \$10.00 per class
Judge: TBC

Pony Club Paddock Ring One
Prize Money: 1st \$20; 2nd \$15; 3rd \$10

Entries close online with Evo Events on Saturday 9th November at midnight.

Section is a qualifier for Horse of the Year 2025

Working Hunters are required to demonstrate jumping ability and be of good strong confirmation with good manners, sound paces and be a comfortable ride over long distances. They will be required to jump a minimum of three (3) hunter type fences.

Jumping style and ability 40%, confirmation 30%, paces and manners 30%.

RULES:

1. RAS rules apply to all showing, sport and pleasure horse competitors.
2. The RAS Judges & Competitors Rulebook (see www.ras.org.nz) sets out all the conditions that apply to the classes and sections offered.
3. Should any person or firm be disqualified or suspended by another Association or affiliated organisation of the Royal Agricultural Society, the suspension or disqualification may also be applied by the affiliate organisations.
4. Pony will be required to gallop within the confines and constraints of the venue.
5. No boots or bandages permitted.
6. One rider per pony

404 Working Hunter Pony: Novice, 0-5 wins

405 Working Hunter Pony: Open, not exceeding 138cm

406 Working Hunter Pony: Open, over 138cm & not exceeding 148cm

**Champion & Reserve Open Working Hunter Pony
Winner to receive the Glynmawr Berwyn (Snowy) Memorial Challenge Cup.**

To be judged from winners of classes 405 & 406. Second place to the Champion to be judged alongside the remaining winner for Reserve Champion

HUNTER JUMPING PONY SECTION

Friday 15th November 2024 – To follow Working Hunter Pony Pony Club Paddock Ring One
Entry Fee: \$10.00 per class Prize Money: 1st \$20; 2nd \$15; 3rd \$10
Judge: TBC

Entries close online with Evo Events on Saturday 9th November at midnight.

Section is a qualifier for Horse of the Year 2025

RULES:

7. RAS rules apply to all showing, sport and pleasure horse competitors.
8. The RAS Judges & Competitors Rulebook (see www.ras.org.nz) sets out all the conditions that apply to the classes and sections offered.
9. Should any person or firm be disqualified or suspended by another Association or affiliated organisation of the Royal Agricultural Society, the suspension or disqualification may also be applied by the affiliate organisations.
10. Pony will be required to gallop within the confines and constraints of the venue.
11. No boots or bandages permitted.
12. One rider per pony

407 Hunter Jumping Pony: Novice, over fences, 0-5 wins

408 Hunter Jumping Pony: Open, over fences, not exceeding 138cm

409 Hunter Jumping Pony: Open, over fences, over 138cm & not exceeding 148cm

Champion & Reserve Hunter Jumping Pony

To be judged from winners of classes 408 & 409. Second place to the Champion to be judged alongside the remaining winner for Reserve Champion

410 Hunter Jumping Pony: The Huntman's Class

Ponies entering this class must have hunted the past season, junting coats are encouraged but not compulsory

411 Hunter Jumping Pony: Best Rider over fences, 14 years & under

412 Hunter Jumping Pony: Best Rider over fences, 15 & 16 years

**Champion & Reserve Hunter Jumping Pony Rider Over Fences
Winner to receive W.H Barkla Challenge Trophy**

To be judged from winners of classes 411 & 412. Second place to the Champion to be judged alongside the remaining winner for Reserve Champion

WORKING HUNTER HORSE SECTION

Friday 15th November 2024 – Not before 1pm
Entry Fee: \$10.00 per class
Judge: TBC

Pony Club Paddock Ring One
Prize Money: 1st \$20; 2nd \$15; 3rd \$10

Entries close online with Evo Events on Saturday 9th November at midnight.

Section is a qualifier for Horse of the Year 2025

Working Hunters are required to demonstrate jumping ability and be of good strong confirmation with good manners, sound paces and be a comfortable ride over long distances. They will be required to jump a minimum of three (3) hunter type fences.

Jumping style and ability 40%, confirmation 30%, paces and manners 30%.

RULES:

1. RAS rules apply to all showing, sport and pleasure horse competitors.
2. The RAS Judges & Competitors Rulebook (see www.ras.org.nz) sets out all the conditions that apply to the classes and sections offered.
3. Should any person or firm be disqualified or suspended by another Association or affiliated organisation of the Royal Agricultural Society, the suspension or disqualification may also be applied by the affiliate organisations.
4. Horse will be required to gallop within the confines and constraints of the venue.
5. No boots or bandages permitted.
6. One rider per horse

413 Working Hunter Horse: Novice, 0-5 wins

Winner to receive Bublitz Estate Working Hunter Challenge Trophy

414 Working Hunter Horse: Open, over 148cm & not exceeding 158cm

415 Working Hunter Horse: Open, over 158cm & not exceeding 163cm

416 Working Hunter Horse: Open, over 163cm

Winner to receive Egmont A & P Working Hunter Cup & Dress Rug kindly sponsored by Hunter Road Stables

To be judged from winners of classes 414, 415 & 416.

Second place to the Champion to be judged alongside the remaining winner for Reserve Champion

HUNTER JUMPING HORSE SECTION

Friday 15th November 2024 – To follow Working Hunter horse

Entry Fee: \$10.00 per class

Judge: TBC

Pony Club Paddock Ring One

Prize Money: 1st \$20; 2nd \$15; 3rd \$10

Entries close online with Evo Events on Saturday 9th November at midnight.

Section is a qualifier for Horse of the Year 2025

RULES:

1. RAS rules apply to all showing, sport and pleasure horse competitors.
2. The RAS Judges & Competitors Rulebook (see www.ras.org.nz) sets out all the conditions that apply to the classes and sections offered.
3. Should any person or firm be disqualified or suspended by another Association or affiliated organisation of the Royal Agricultural Society, the suspension or disqualification may also be applied by the affiliate organisations.
4. Horse will be required to gallop within the confines and constraints of the venue.
5. No boots or bandages permitted.
6. One rider per horse

417 Hunter Jumping Horse: Novice, over fences, 0-5 wins

418 Hunter Jumping Horse: Open, over fences, over 148cm & not exceeding 163cm

419 Hunter Jumping Horse: Open, over fences, over 163cm

420 Hunter Jumping Horse: Open, over 148cm

Champion & Reserve Hunter Jumping Horse *Dress Rug kindly sponsored by Hunter Road Stables*

To be judged from winners of classes 418, 419 & 420. Second place to the Champion to be judged alongside the remaining winner for Reserve Champion

421 Hunter Jumping Horse: The Huntsman Class

Horses entering this class must have hunted the past season, hunting coats are encouraged but not compulsory.

422 Hunter Jumping Horse: Novice Adult Rider, over fences, 0-5 wins

423 Hunter Jumping Horse: Best Rider over fences 17-20 years

424 Hunter Jumping Horse: Best Rider over fences, 21 years & over

Champion & Reserve Hunter

Jumping Horse Senior Rider Over Fences

To be judged from winners of classes 423 & 424.

Second place to the Champion to be judged alongside the remaining winner for Reserve Champion



LED HORSE SECTION

Friday 15th November 2024 – Not before 10am
Entry Fee: \$10.00 per class
Judge: TBC

Pony Club Paddock Ring Two
Prize Money: 1st \$20; 2nd \$15; 3rd \$10

**Entries close online with Evo Events on Saturday 9th November at midnight.
Section is a qualifier for Horse of the Year 2025**

RULES:

1. RAS Height Certificate must be carried at all times & presented upon request, otherwise the competitor will not be allowed to start.
2. Exhibit Number - It is compulsory to display your exhibit number when in the judging ring.

425 Led Horse: Best Presented

426 Led Horse: Foal or yearling, any sex, to mature over 148cm

427 Led Horse: 2 & 3 year old, any sex, to mature over 148cm

Champion & Reserve Young Stock Led Horse

To be judged from winners of classes 426 & 427. Second place to the Champion to be judged alongside the remaining winners for Reserve Champion.

428 Led Horse: Youngstock Best Paced and Mannered

429 Led Horse: Stallion, 4 years & over, over 148cm

430 Led Horse: Gelding 4 years & over, over 148cm

431 Led Horse: Broodmare or dry mare 4 years & over, over 148cm

Champion & Reserve Adult Led Horse

*To be judged from winners of classes 429, 430 & 431.
Second place to the Champion to be judged alongside the remaining winners for Reserve Champion*

Supreme Champion Led Horse

*To be judged from the Champion Adult & Champion Young stock Led Horse
Garland Sponsored by: Bublitz Estate Holsteiners*

432 Led Horse: Registered warmblood NZWBA
(Must be registered with NZWBA. Proof of registration must be uploaded to your Evo Events account and documentation produced on show day if required)

NZ Warmblood Association are sponsoring the sashes for this class

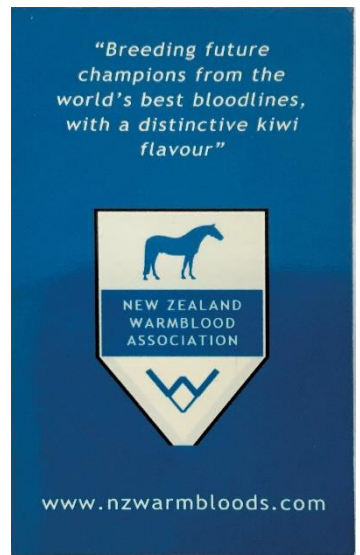

433 *Led Horse: Adult Best Paced & Mannered*

434 *Led Horse: Suitability for Hack classes, any age*

435 *Led Horse: Suitability for Dressage classes, any age*

436 *Led Horse: Suitability for Eventing, Show Jumping and Hunting, any age*

LED PONY SECTION

Friday 15th November 2024 – Not before 1pm
Entry Fee: \$10.00 per class
Judge: TBC

Pony Club Paddock Ring Two
Prize Money: 1st \$20; 2nd \$15; 3rd \$10

Entries close online with Evo Events on Saturday 9th November at midnight.

Section is a qualifier for Horse of the Year 2025

RULES:

1. RAS Height Certificate must be carried at all times & presented upon request, otherwise the competitor will not be allowed to start.
2. Exhibit Number - It is compulsory to display your exhibit number when in the judging ring.

437 Led Pony: Best Presented Pony & Handler

438 Led Pony: Yearling, not exceeding 140cm (any type)

Winner to receive Kilmarnock Pony Stud Challenge Cup

439 Led Pony: Show Pony type 2 & 3 year old, not exceeding 148cm

440 Led Pony: Saddle Hunter type, 2 & 3 years, not exceeding 148cm

Champion & Reserve Youngstock Led Pony

*To be judged from winners of classes 438, 439 & 440.
Second place to the Champion to be judged alongside the remaining
winners for Reserve Champion*

441 Led Pony: Youngstock Best Paced & Mannered

442 Led Pony: Stallion, not exceeding 148cm

443 Led Pony: Broodmare, not exceeding 148cm

444 Led Pony: Dry Mare, 4 years & over, not exceeding 148cm

445 Led Pony: Gelding, 4 years & over, not exceeding 148cm

Champion & Reserve Adult Led Pony

*To be judged from winners of classes 442 & 443, 444 & 445.
Second place to the Champion to be judged alongside the remaining winners for
Reserve Champion.*

Supreme Champion Led Pony

To be judged from Champion Adult and Champion Young Stock led Pony

446 Led Pony: Adult Best Paced & Mannered

447 Led Pony: Registered Pure Breed Welsh

448 Led Pony: Registered Part Breed Welsh

(Classes 447 & 448 Must be registered with WPCSNZ. Proof of registration must be uploaded to your Evo Events account and documentation produced on show day if required)



Show Ponies not exceeding 148 cm

Saturday 16th November 2024 – 8.30 am
Entry Fee: \$10.00 per class
Judge: TBC

Pony Club Paddock Ring One
Prize Money: 1st \$20; 2nd \$15; 3rd \$10

Entries close online with Evo Events on Saturday 9th November at midnight.

Section is a qualifier for Horse of the Year 2025

RULES:

1. A Pony may only be entered in either the Show Pony Section or the Saddle Hunter Pony Section
2. RAS Height Certificate & Novice Status Cards must be carried at all times & presented upon request, otherwise the competitor will not be allowed to start.
3. Ponies to be up to and including 148cm.
4. All riders must be under 17 years of age excluding Novice classes as at 1st August 2024.
5. All novice pony classes are open to riders of any age.
6. Exhibit Number - It is compulsory to display your exhibit number when in the judging ring.

100 Best Presented

102 Novice Show Pony, 0-2 wins not exceeding 148cm

104 Novice Show Pony, 0-5 wins not exceeding 128cm

106 Novice Show Pony, 0-5 wins over 128cm and not exceeding 138cm

108 Novice Show Pony, 0-5 wins over 138cm and not exceeding 148cm

****** Champion & Reserve Novice Show Pony**

Winners from classes 102 to 108, Second placed Novice Show Pony to the Champion to be judged alongside the remaining winners for Reserve Champion

110 Novice Paced and Mannered Show Pony, 0-5 wins, not exceeding 148cm

112 Open Show Pony, not exceeding 123cm

114 Open Show Pony, over 123cm and not exceeding 128cm

****** Champion and Reserve Champion Open Small Show Pony**

Not exceeding 128cm. To be judged from classes 112 & 114. Second placed Show Pony to the Champion to be judged alongside the remaining winners for Reserve Champion

116 Open Show Pony, over 128cm and not exceeding 133cm

118 Open Show Pony, over 133cm and not exceeding 138cm

****** Champion and Reserve Champion Open Medium Show Pony**

Over 128cm and not exceeding 138cm To be judged from classes 116 & 118. Second placed Show Pony to the Champion to be judged alongside the remaining winners for Reserve Champion

- 120 Open Show Pony, over 138cm and not exceeding 143cm
122 Open Show Pony, over 143cm and not exceeding 148cm
****** Champion and Reserve Champion Open Large Show Pony**
Over 138cm and not exceeding 148cm

*To be judged from classes 120 & 122. Second placed Show Pony to the Champion to be judged alongside the remaining winners for Reserve Champion
Trophy: Arthur Brown Construction Challenge Cup*

- 124 Open Paced and Mannered Show Pony not exceeding 148cm

****** Supreme Champion Pony ******

To be judged from both Open Champions from Show Pony & Saddle Hunter Pony Rings

- 126 **Best Registered Pony –**
Ring 2

Prize Money: Ribbons to 4th only

Judge: TBC

To be judged under saddle. Ponies must be registered with a recognised Breed Society.
Proof to be available to the steward upon request at the ring.

Rider Classes - Under 17 Years

Saturday 16th November 2024 – After Pleasure Horse & Saddle Hunter Pony Classes

Entry Fee: \$10.00 per class
Judge: TBC

Pony Club Paddock Ring One
Prize Money: 1st \$20; 2nd \$15; 3rd \$10

Entries close online with Evo Events on Saturday 9th November at midnight.

Section is a qualifier for Horse of the Year 2025

RULES:

1. Riders may compete in rider classes from any section of the Show Pony Section or the Saddle Hunter Pony Sections
2. Ponies to be up to and including 148cm.
3. Local Rider: Rider must reside within area bounded by Whenuakura River, Parihaka Road, inland to Eltham - Opunake & Wiremu Road.

- 130 Best Novice Junior Rider, 0-5 wins
Trophy: Golden Tan Saddlery Cup
- 132 Best Rider, 11 years and under
- 134 Best Rider, 12, 13 and 14 years
- 136 Best Rider, 15 and 16 years
Trophy: AB Cunningham Challenge Trophy

****** Champion and Reserve Champion Junior Rider**

To be judged from the Junior winners of classes 132 to 136 Second placed Junior Rider to the Champion to be judged alongside the remaining winners for Reserve Champion
Trophy: Catherine Mann Trophy

- 144 Local Rider - No entry fee. Snaffle bridle only. Previous winner excluded. Rider under 21 years on horse or pony any height. Combination must have attended 3 Pony Club rallies in the current season.
Trophy: Appleyard Memorial Trophy

Park Hacks & Hacks

Saturday 16th November 2024, not before 1pm
Entry Fee \$10.00 per class

Pony Club Paddock Ring One
Prize Money: 1st \$20; 2nd \$15 3rd \$10

Judge: TBC

Entries close online with Evo Events on Saturday 9th November at midnight.

Section is a qualifier for Horse of the Year 2025

RULES:

1. An exhibit may only be entered in either the Show Hack or Riding Horse or Saddle Hunter section.
2. RAS Height Certificate & Novice Status Cards must be carried at all times.
3. Exhibit number - It is compulsory to display your exhibit number while in the judging ring.
4. Small Hacks must be over 148cm and not exceeding 158cm

- 146 Best Presented
- 148 Novice Small Hack not exceeding 158cm, 0-2 wins
- 150 Novice Small Hack not exceeding 158cm, 0-5 wins
- 152 Novice Hack over 158cm, 0-2 wins
- 154 Novice Hack over 158cm, 0-5 wins

**** Champion & Reserve Novice Hack

Winners in classes 148 to 154 Second placed Novice Hack to the Champion to be judged alongside the remaining winners for Reserve Champion Novice Hack

- 156 Novice Paced and Mannered Hack, 0-5 wins
- 158 Open Small Lady's Hack on Type over 148cm and not exceeding 158cm Lady or Gentleman Rider
- 160 Open Small Gentleman's Hack on Type over 148cm and not exceeding 158cm Lady or Gentleman Rider
- 162 Open Large Lady's Hack on Type over 158cm. Lady or Gentleman Rider
- 164 Open Large Gentleman's Hack on Type over 158cm. Lady or Gentleman Rider
- 166 Open Small Hack, over 148cm and not exceeding 153cm
- 168 Open Small Hack, over 153cm and not exceeding 158cm
- 170 Open Large Hack, over 158cm and not exceeding 163cm
- 172 Open Large Hack, over 163cm

**** Champion and Reserve Champion Open Small Hack

To be judged from classes 166 & 168

Second placed Open Small Hack to the Champion to be judged alongside the remaining winners for Reserve Champion Open Small Hack.

**** Champion and Reserve Champion Open Large Hack

To be judged from classes 170 & 172

Second placed Large Hack to the Champion to be judged alongside the remaining winners for Reserve Champion Open Large Hack.

- 174 Open Paced and Mannered Small Hack, over 148cm and not exceeding 158cm
- 176 Open Paced and Mannered Large Hack over 158cm

**** Supreme Champion Horse ****

To be judged from the Four Open Champions of the Riding Horse, Hack & Saddle Hunter rings

188 **Best Registered Horse (Excluding Thoroughbreds)**

Ring 1

Prize Money: Ribbons to 4th only

Judge: TBC

Horses must be registered with a recognised Breed Society.

Proof to be available to the steward upon request at the ring.

This is a restricted breed class and does not count as a win for Novice Horses.

Judging criteria will be 80% Conformation, 20% Manners & Paces.

Judges will assess each horse individually and may ask for saddles to be removed after they have been assessed ridden.

190 **NZTR Thoroughbred A&P Show Series**

Ring 2

Judge: TBC



Entry Fee: \$10.00

- No entries accepted after entries have closed.
- Thoroughbred horse - registered in any recognised Thoroughbred Stud Book, either in NZ or overseas.
- Sire and Dam of Thoroughbred - must be listed at time of entry. If not listed, then the entry will not be accepted the Show/Event

Prize Money – 1 \$100; 2 \$50; 3 \$30; 4 \$20 will be awarded if 4 or more entries are in the class at close of entry date. 3 entries or less – no prize money awarded.

Ribbons – Awarded to fourth place.

Series Winner 2024.2025 – will be announced at HOY 2025.

Judging: 80% Conformation, 20% Paces & Manners.

Judges to assess each Horse individually with Saddles removed.

After they have been assessed, Ridden Horses to Show true Thoroughbred qualities. Horses to show a good Walk as well as Gallop (room permitting).

Fred & Eunice Rodie

CHARITABLE TRUST

The Fred and Eunice Rodie Charitable Trust was set up in 1988 by the late Eunice Rodie to recognize and perpetuate the shared interest of herself and Fred in the South Taranaki Community. Fred and Eunice Rodie were both from local families and lived and worked in the South Taranaki Community. In absence of family of their own, Fred and Eunice generously donated substantial assets within their charitable trust for the benefit of the wider community. Fred's father was Station Master of the Hawera Railway Station and his brother Town Clerk at Manaia. Eunice Nicholas grew up in Caledonia Street, Her father John was a beekeeper.

Fred and Eunice lived in Kaponga where Fred was Branch Manager of Newton King Ltd. In 1948 they moved to Hawera as Fred became Manager of the Hawera branch. Eunice did secretarial work for Walkley and Laurance Accountants in Hawera. They bought a farm on the Skeet Road and one on the Auroa Road. Throughout their lives they both took a great interest in the farming operations. Fred being a meticulous manager and record keeper in his work and farming operations.

They were kind, friendly, private people who enjoyed being involved. Fred was very involved with Rotary and contributed generously to many worthy causes in our local community, for example; to the Rotary organised Intensive Care and Scanner Trusts, and a Hall of Residence at Massey University. Eunice was very involved in the St Mary's Church and for a number of years was Fellowship Secretary.

Fred retired from Newton King when he was 60 in 1970. He and Eunice continued to live in their 57 Disraeli Street home (next to Bayly Park) until Fred died in 1974. Eunice soon after moved into a unit in Argyle Street until her health required admission to Calvery/Trinity rest home/hospital. Fred Rodie Born 1910 died 1974. Eunice Luxford Rodie Born 1910 died 2000.

WT & LM Smyth

Lead Rein

Saturday 16th November 2024, 8.30am

Entry Fee: \$7.00 per class

Judge: TBC

Venue: Pony Club Paddock Ring Two

Ribbons Only 1st – 3rd

Entries close online with Evo Events on Saturday 9th November at midnight.

Section is a qualifier for Horse of the Year 2025

Rules:

1. Riders in this section may not enter any other section, unless in an affiliated Breed Section Lead Rein class.
2. Ponies will be asked to walk and trot – no cantering under any circumstances.
3. RAS Height Certificate & Novice Status Cards must be carried at all times.
4. Exhibit Number - It is compulsory to display your exhibit number when in the judging ring.

184 Best Presented Lead Rein Pony, Rider & Handler

186 Novice Lead Rein Pony, not exceeding 128cm – 0-5 wins.

188 Open Lead Rein Pony, not exceeding 123cm

190 Open Lead Rein Pony, over 123cm and not exceeding 128cm

**** **Champion and Reserve Champion Lead Rein Pony**

To be judged from the winners of classes 186, 188, 190. Second placed Lead Rein Pony to the Champion to be judged alongside the remaining winners for Reserve Champion

192 Open Paced and Mannered Lead Rein Pony

194 Best Lead Rein Rider

196 Egmont Show Lead Rein "Future Star" - Sashes to 3rd. *Riders will be able to compete in the ring without a Handler. Please only enter if your child is capable to manage their pony on their own. This class is designed for the more competent combinations to have a go on their own in a competition environment without penalty of having to move to the FYR ring.*

WT & LM Smyth

First Ridden

Saturday 16th November 2024, to follow on from Lead Rein
Ring Two Entry

Fee: \$7.00 per class

Venue: Pony Club Paddock
Ribbons Only 1st – 3rd

Judge: TBC

Entries close online with Evo Events on Saturday 9th November at midnight.

Section is a qualifier for Horse of the Year 2025

Rules:

1. Riders in this section may not enter any other section, unless in a First Ridden class in a Breed section.
2. RAS Height Certificate & Novice Status Cards must be carried at all times.
3. Exhibit Number - It is compulsory to display your exhibit number when in the judging ring.

- 198 Best Presented First Ridden Pony & Rider
200 Novice First Ridden Pony, not exceeding 138cm - 0-5 wins
202 Open First Ridden Pony, not exceeding 128cm
204 Open First Ridden Pony, over 128cm and not exceeding 138cm

**** Champion and Reserve Champion First Ridden Pony

To be judged from the winners of classes 200, 202, 204. Second placed First Ridden Pony to the Champion to be judged alongside the remaining winners for Reserve Champion

- 206 Novice Paced and Mannered First Ridden Pony 0-5 wins
208 Open Paced and Mannered First Ridden Pony
210 Novice Rider (First Ridden Section) 0-5 wins
212 Open Rider (First Ridden Section)
214 Egmont Show FYR "Future Star" – Sashes to 3rd. *Riders will be able to canter on the circle in a group. Please only enter your child in this class if they are able to manage their pony in this situation. This class is designed for the more competent combinations to have a go cantering on the circle in a competition environment without penalty of having to move to the Open ring.*

Saddle Hunter Ponies Not Exceeding 148cm

Saturday 16th November 2024, To follow Pleasure Pony Venue: Pony Club Paddock
Ring 3 Entry Fee: \$10.00 per class Prize Money: 1st \$20; 2nd \$15; 3rd \$10

Judge: TBC

Entries close online with Evo Events on Saturday 9th November at midnight.

Section is a qualifier for Horse of the Year 2025

RULES:

1. A Pony may only be entered in either the Show Pony Section or the Saddle Hunter Pony Section
2. RAS Height Certificate & Novice Status Cards must be carried at all times.
3. Ponies not to exceed 148cm.
4. All riders must be under 17 years of age excluding Novice classes as at 1st August 2024.
5. All Novice pony classes are open to riders of any age.
6. Exhibit Number - It is compulsory to display your exhibit number when in the judging ring.

- 216 Best Presented
218 Novice Saddle Hunter Pony, 0-2 wins not exceeding 148cm
220 Novice Saddle Hunter Pony, 0-5 wins not exceeding 128cm
222 Novice Saddle Hunter Pony, 0-5 wins over 128cm and not exceeding 138cm
224 Novice Saddle Hunter Pony, 0-5 wins over 138cm and not exceeding 148cm

**** **Champion and Reserve Champion Novice Saddle Hunter Pony**

To be judged from the winners of above class 218 - 224. Second placed Novice Saddle Hunter Pony to the Champion to be judged alongside the remaining winners for Reserve Champion

- 226 Novice Paced and Mannered Saddle Hunter Pony, not exceeding 148cm, 0-5 wins
228 Open Saddle Hunter Pony, not exceeding 123cm
230 Open Saddle Hunter Pony over 123cm and not exceeding 128cm

**** **Champion and Reserve Champion Open Small Saddle Hunter Pony**

To be judged from classes 228 & 230. Second placed Saddle Hunter Pony to the champion to be judged alongside the remaining winners for Reserve Champion

- 232 Open Saddle Hunter Pony, over 128cm and not exceeding 133cm
234 Open Saddle Hunter Pony, over 133cm and not exceeding 138cm

**** **Champion and Reserve Champion Open Medium Saddle Hunter Pony**

To be judged from classes 232 & 234 Second placed Saddle Hunter Pony to the Champion to be judged alongside the remaining winners for Reserve Champion

236 Open Saddle Hunter Pony, over 138cm and not exceeding 143cm

238 Open Saddle Hunter Pony, over 143cm and not exceeding 148cm

****** Champion and Reserve Champion Open Large Saddle Hunter Pony**

To be judged from classes 236 & 238. Second placed Saddle Hunter Pony to the Champion to be judged alongside the remaining winners for Reserve Champion

240 Open Paced and Mannered Saddle Hunter Pony, not exceeding 148cm

****** Supreme Champion Pony ******

To be judged from both Champions from Open Show Pony & Open Saddle Hunter Pony Rings

126 **Best Registered Pony –**

Ring 2

Prize Money: Ribbons to 4th only

Judge: TBC

To be judged under saddle. Ponies must be registered with a recognised Breed Society. Proof to be available to the steward upon request at the ring

Saddle Hunter Horse - Over 148cm

Saturday 16th November 2024, not before 1pm
Ring Two
Prize Money: 1st \$20; 2nd \$15; 3rd \$10

Venue: Pony Club Paddock
Entry Fee: \$10.00 per class

Judge: TBC

Entries close online with Evo Events on Saturday 9th November at midnight.

Section is a qualifier for Horse of the Year 2025

RULES:

1. An exhibit may only be entered in either the Show Hack or Riding Horse or Saddle Hunter section.
2. Horses will be required to gallop within the confines and constraints of the venue.
3. RAS Height Certificate & Novice Status Cards must be carried at all times
4. Exhibit number - It is compulsory to display your exhibit number while in the judging ring

242 Best Presented

244 Novice Saddle Hunter, 0-2 wins

246 Novice Saddle Hunter, 0-5 wins

****** Champion and Reserve Champion Novice Saddle Hunter**

To be judged from the winners of classes 244 & 246. Second placed Novice Saddle Hunter to the Champion to be judged alongside the remaining winners for Reserve Champion

248 Novice Paced and Mannered Saddle Hunter, 0-5 wins

250 Open Lady's Saddle Hunter on Type. May be ridden by a Lady or Gentleman

252 Open Gentleman's Saddle Hunter on Type. May be ridden by a Lady or Gentleman

258 Open Saddle Hunter over 148 cm not exceeding

260 Open Saddle Hunter over 163 cm

****** Champion and Reserve Champion Open Saddle Hunter**

be judged from the winners of classes 258 to 260 Second placed Saddle Hunter to the Champion to be judged alongside the remaining winners for reserve

262 Open Paced and Mannered Saddle Hunter

****** Supreme Champion Horse ******

To be judged from the Four Open Champions of the Riding Horse, Hack & Saddle Hunter rings

188 **Best Registered Horse (Excluding Thoroughbreds)**

Ring 1

Prize Money: Ribbons to 4th only

Judge: TBC

Horses must be registered with a recognised Breed Society.

Proof to be available to the steward upon request at the ring.

This is a restricted breed class and does not count as a win for Novice Horses.

Judging criteria will be 80% Conformation, 20% Manners & Paces.

Judges will assess each horse individually and may ask for saddles to be removed after they have been assessed ridden.

190 **NZTR Thoroughbred A&P Show Series**

Ring 2

Judge: TBC

Sponsored by



Entry Fee: \$10.00

- No entries accepted after entries have closed.
- Thoroughbred horse - registered in any recognised Thoroughbred Stud Book, either in NZ or overseas.
- Sire and Dam of Thoroughbred - must be listed at time of entry. If not listed, then the entry will not be accepted the Show/Event

Prize Money – 1 \$100; 2 \$50; 3 \$30; 4 \$20 will be awarded if 4 or more entries are in the class at close of entry date. 3 entries or less – no prize money awarded.

Ribbons – Awarded to fourth place.

Series Winner 2024.2025 – will be announced at HOY 2025.

Judging: 80% Conformation, 20% Paces & Manners.

Judges to assess each Horse individually with Saddles removed.

After they have been assessed, Ridden Horses to Show true Thoroughbred qualities. Horses to show a good Walk as well as Gallop (room permitting).

Senior Rider Classes

Saturday 16th November 2024 - After Saddle Hunters
Entry Fee \$10.00 per class

Pony Club Paddock Ring Three
Prize Money: 1st \$20; 2nd \$15 3rd \$10

Judge: TBC

Entries close online with Evo Events on Saturday 9th November at midnight.

Section is a qualifier for Horse of the Year 2025

- 264 Best Novice Rider, 17 years and over, 0-5 wins
- 266 Youth or Girl Best Rider, 17 years and under 21 years
- 268 Best Rider, 21 years and over

****** Champion and Reserve Champion Senior Adult Rider******

To be judged from winners of classes 266 & 268. Second placed Rider to the Champion to be judged alongside the remaining winners for Reserve Champion



Riding Horse Over 148cm

Saturday 16th November 2024, not before 1pm
Entry Fee \$10.00 per class

Pony Club Paddock Ring Three
Prize Money: 1st \$20; 2nd \$15 3rd \$10

Judge: TBC

Entries close online with Evo Events on Saturday 9th November at midnight.

Section is a qualifier for Horse of the Year 2025

RULES

1. An exhibit may only be entered in either the Show Hack or Riding Horse or Saddle Hunter section.
2. Horses will be required to gallop within the confines and constraints of the venue.
3. RAS Height Certificate & Novice Status Cards must be carried at all times & presented upon request, otherwise the competitor will not be allowed to start.
4. Exhibit number - It is compulsory to display your exhibit number while in the judging ring.

270 Best Presented

272 Novice Riding Horse, 0-2 wins

274 Novice Riding Horse, 0-5 wins

**** **Champion and Reserve Champion Novice Riding Horse.**

To be judged from the winners of classes 272 & 274 Second placed Novice Riding Horse to the Champion to be judged alongside the remaining winners for Reserve Champion)

276 Novice Paced & Mannered Riding Horse, 0 – 5 wins

278 Open Lady's Riding Horse, on Type. May be ridden by a Lady or a Gentleman

280 Open Gentleman's Riding Horse on Type. May be ridden by a Lady or Gentleman

282 Open Riding Horse, over 148cm and not exceeding 158cm

284 Open Riding Horse, over 158cm and not exceeding 163cm

286 Open Riding Horse, over 163cm

**** **Champion and Reserve Champion Open Riding Horse**

To be judged from the winners of classes 282, 284 and 286 Second placed Riding Horse to the Champion to be judged alongside the remaining winners for Reserve Champion

288 Open Paced and Mannered Riding Horse

**** **Supreme Champion Horse** ****

To be judged from the Four Open Champions of the Riding Horse, Hack & Saddle Hunter rings

188 **Best Registered Horse (Excluding Thoroughbreds)**

Ring 1

Prize Money: Ribbons to 4th only

Judge: TBC

Horses must be registered with a recognised Breed Society.

Proof to be available to the steward upon request at the ring.

This is a restricted breed class and does not count as a win for Novice Horses.

Judging criteria will be 80% Conformation, 20% Manners & Paces.

Judges will assess each horse individually and may ask for saddles to be removed after they have been assessed ridden.

190 **NZTR Thoroughbred A&P Show Series**

Ring 2

Judge: TBC

Sponsored by



Entry Fee: \$10.00

- No entries accepted after entries have closed.
- Thoroughbred horse - registered in any recognised Thoroughbred Stud Book, either in NZ or overseas.
- Sire and Dam of Thoroughbred - must be listed at time of entry. If not listed, then the entry will not be accepted the Show/Event

Prize Money – 1 \$100; 2 \$50; 3 \$30; 4 \$20 will be awarded if 4 or more entries are in the class at close of entry date. 3 entries or less – no prize money awarded.

Ribbons – Awarded to fourth place.

Series Winner 2024.2025 – will be announced at HOY 2025.

Judging: 80% Conformation, 20% Paces & Manners.

Judges to assess each Horse individually with Saddles removed.

After they have been assessed, Ridden Horses to Show true Thoroughbred qualities. Horses to show a good Walk as well as Gallop (room permitting).

Show Pleasure Section

Entries close online with Evo Events on Saturday 9th November at midnight.

Please refer to the NZEPS website for more information, allowable saddlery and dress, class descriptions, how to join and upcoming shows.

<https://nzequestrianpleasure.files.wordpress.com>

Rules.

1. Riders and mounts may be fully registered with ESNZ.
2. All Pleasure classes will be run under NZ Equestrian Pleasure Society Rules (NZEPS).
3. Classes are open to NZEPS registered riders and horses/ponies as well as to unregistered riders and horses/ponies. However unregistered horses gaining champions or reserves will not count towards HOY 2025 qualifying
4. Mounts must not have place 1st in an RAS Affiliated show in an open showing class i.e Saddle Hunter, Working Hunter etc (Dispensation can be applied for to NZEPS)
5. Not open to mounts competing in RAS showing classes.
6. Mount may be any size.
7. Adults may ride ponies in hack classes. Children on a hack must ride in the hack ring.
8. Simple Snaffle bits only may be used (as defined by Dressage NZ)
9. Whips may be used but they must not be over 76cms in length. Dressage whips are not allowed.
10. Spurs or flashes or any strapping below the bit are not to be used.
11. Competitors must adhere to RAS/NZEF rules.
12. This show is a Qualifying Show for National Regional Award Points Prize and Championship Class at NZ National Horse and Pony Show.

Show Pleasure Horse

Saturday 16th November 2024 following Show Ponies Pony Club Paddock, Ring One

Entry Fee \$8.00 per class

Prize Money: 1st \$15; 2nd \$10; 3rd \$5; 4th Ribbon

Judge: TBC

Entries close online with Evo Events on Saturday 9th November at midnight.

- 290 Best Groomed & Cared for Horse
- 292 Best Paced & Mannered Horse
- 294 Best Suited for a Learner Horse
- 296 Best Combination
- 298 Best Registered Combination (Open to NZEPS Members Only) – Ribbons supplied by NZEPS

- 300 Best Low Jump
- 302 Best Rider 18 years and over

****** Champion & Reserve Pleasure Horse ****
Winners from Classes 292, 294, 296 & 298**

Show Pleasure Pony

Saturday 16th November 2024 8.30am
Entry Fee \$8.00 per class

Pony Club Paddock, Ring Three
Prize Money: 1st \$15; 2nd \$10; 3rd \$5; 4th Ribbon

Judge: TBC

Entries close online with Evo Events on Saturday 9th November at midnight.

- 304 Best Groomed & Cared for Pony
- 306 Best Paced & Mannered Pony
- 308 Best Suited for a Learner Pony
- 310 Best Combination
- 312 Best Registered Combination (Open to NZEPS Members only) – Ribbons supplied by NZEPS

- 314 Best Low Jump
- 316 Best Rider 17 Years and Under

****** Champion & Reserve Pleasure Pony ****
Winners from Classes 306, 308, 310 & 312**

RECREATIONAL/LEISURE SHOWING SECTION

Entries close online with Evo Events on Saturday 9th November at midnight.

Rules

1. Plaiting and riding jackets optional, Riding or Pony Club uniform or tidy appropriate dress.
2. Helmets must be yellow tagged.
3. All mounts must have a bit in their mouth.
4. No height certificate is required.
5. The Egmont A&P Assn reserve the right to make changes/alterations to the program as required.
6. Competitors in these rings cannot enter any other Showing classes during Egmont A&P Show 2024

Sunday 17th November 2024

9.00am

Entry Fee: \$30.00 blanket entry
Judge: TBA

Pony Club Paddock
Ribbons Only

Entries close online with Evo Events on Saturday 9th November at midnight.

All rings classes

1. Best Cared and Presented
2. Best Trot
3. Best Mannered
4. Best Combination
5. Horse or Pony most suited to be a pony club/riding club type mount
6. Horse or Pony most suited to be a CTR type mount
7. Best Rider

***** Champion and Reserve Champion Recreational Mount** (To be judged from winners of classes 4, 5 & 6, with 2nd placegetters on standby)

Class 400 Ring 1 R/L

Recreational/Leisure Horse or Pony – Riders 17 years and over.

Class 401 Ring 2 R/L

Recreational/Leisure Horse or Pony – Riders 10 to 16 years.

Class 402 Ring 3 R/L

Recreational/Leisure Led Pony or Horse – Riders 16 years and under on lead rein.

Class 403 Ring 4 R/L

Recreational/Leisure Led Pony or Horse – Riders 16 years and under, walk and trot in a group, canter optional.

RECREATIONAL/ GRASS ROOTS JUMPING

Sunday 17th November 2024

Pony Club Paddock

Class 500

Not before 11.30am

40cm

50cm

60cm

70cm

Starting at 40cm and going up in 10cm increments to maximum height of 70cm.

Blackboard order

\$5.00 per round – max 3 rounds per mount.
Can be entered via EvoEvents or on the day.

Recycled Ribbons for clear rounds